



Side By Side Dresser

Free Plans to Build a Side By Side Dresser



Materials and Tools

MATERIALS:

- 1-1/4" pocket hole screws
- 1-1/4" brad nails
- 4" furniture legs with mounting plates
- 8 sets of 18" drawer slides
- Cabinet pulls
- Edge banding (optional)
- Wood glue
- Sandpaper (100, 150, 220 grits)
- Finishing supplies (primer & paint, or stain, sealer)

LUMBER:

- 5 - 4' x 4' x 3/4" PureBond plywood project panels
- 1 - 4' x 4' x 1/4" PureBond plywood project panel (Cherry was used in example)

TOOLS:

- Jigsaw, table saw, miter saw, or hand saw
- Pocket hole jig
- Drill
- Brad nailer
- Pencil, ruler, square, tape measure
- Sander
- Iron for edge banding
- Edge banding trimmer or craft knife

CUT LIST:

- 1 - 3/4" plywood at 19-1/2" x 42-1/2" - Bottom
- 2 - 3/4" plywood at 19-1/2" x 31" - Sides
- 1 - 3/4" plywood at 19-1/2" x 31" - Divider
- 2 - 3/4" plywood at 1-1/2" x 41" - Upper Stretchers
- 6 - 3/4" plywood at 1-1/2" x 20-1/8" - Front Stretchers
- 1 - 1/4" plywood at 31-3/4" x 41-3/4" - Back
- 1 - 3/4" plywood at 20-1/4" x 43-1/2" - Top
- 16 - 3/4" plywood at 5-1/2" x 19-1/8" - Drawer Box Front & Back
- 16 - 3/4" plywood at 5-1/2" x 16-1/2" - Drawer Box Sides
- 8 - 3/4" plywood at 16-1/2" x 17-5/8" - Drawer Box Bottom
- 8 - 3/4" plywood at 6-3/4" x 19-7/8" - Drawer Fronts

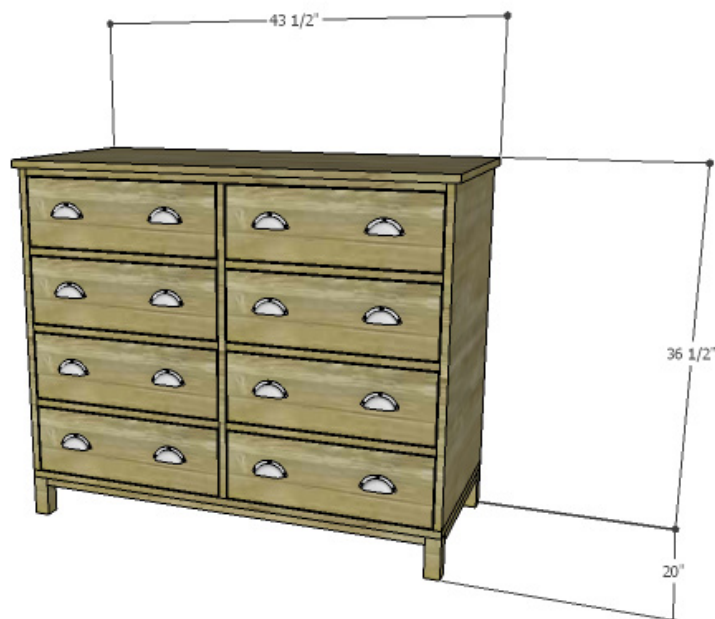

FEATURING
PureBond.
FORMALDEHYDE-FREE TECHNOLOGY



Side By Side Dresser



STEP 1

Notes:

Edge banding will be applied to the exposed edges of the plywood prior to assembly.

Cut the piece for the bottom. Secure the mounting plates to the bottom according to the manufacturer's installation instructions. Add the furniture feet.

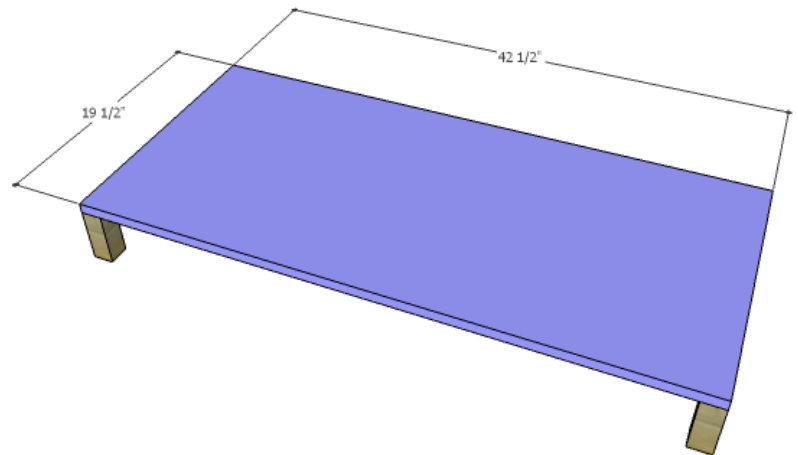

STEP 2

Cut the pieces for the sides. With the pocket hole jig set for $\frac{3}{4}$ " material, drill pocket holes in the lower edges of the sides. Secure the sides, flush with the end edges of the bottom, using glue and 1-1/4" pocket hole screws.

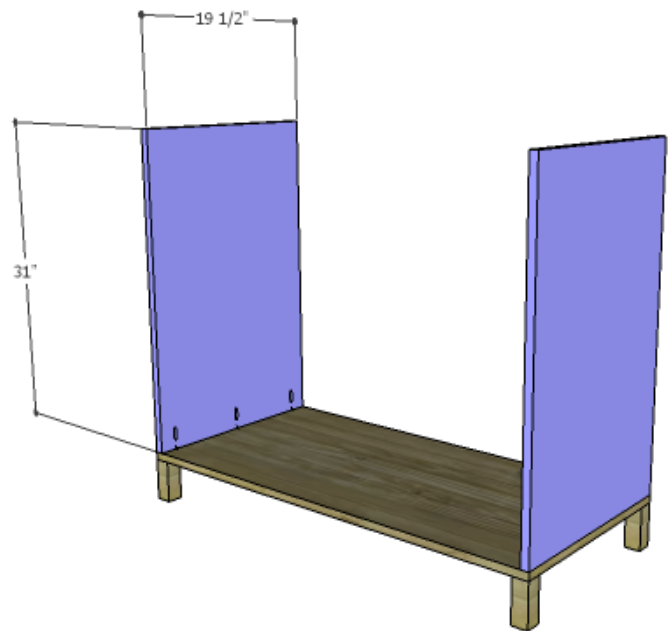



Side By Side Dresser

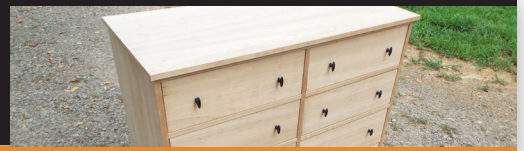

STEP 3

Cut the piece for the divider. Cut the notches using a jigsaw or a bandsaw, and drill pocket holes in the lower edge. Secure the divider to the bottom using glue and 1-1/4" pocket hole screws.

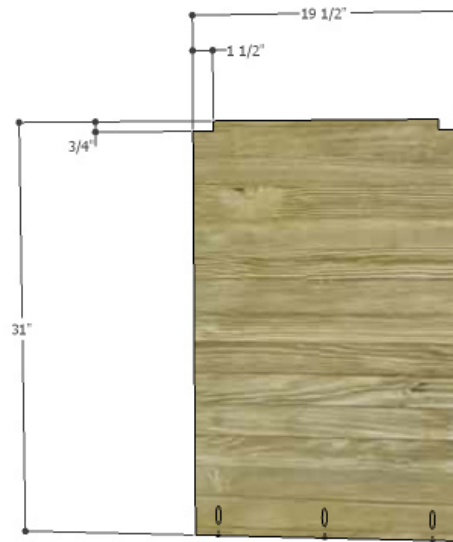

STEP 4

Cut the pieces for the upper stretchers and drill pocket holes in each end. Secure to the sides using glue and 1-1/4" pocket hole screws.

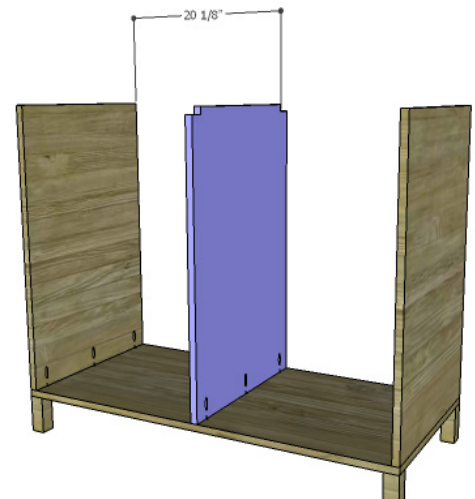

FEATURING
PureBond.
FORMALDEHYDE-FREE TECHNOLOGY



Side By Side Dresser

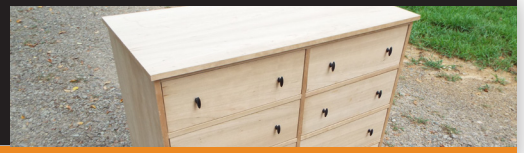

STEP 5

Cut the pieces for the front stretchers. Drill two pocket holes in one end and one pocket hole in the other end off center so it will not conflict with the pocket hole screws on the opposite side of the divider. Secure the stretchers to the sides and dividers using glue and 1-1/4" pocket hole screws.

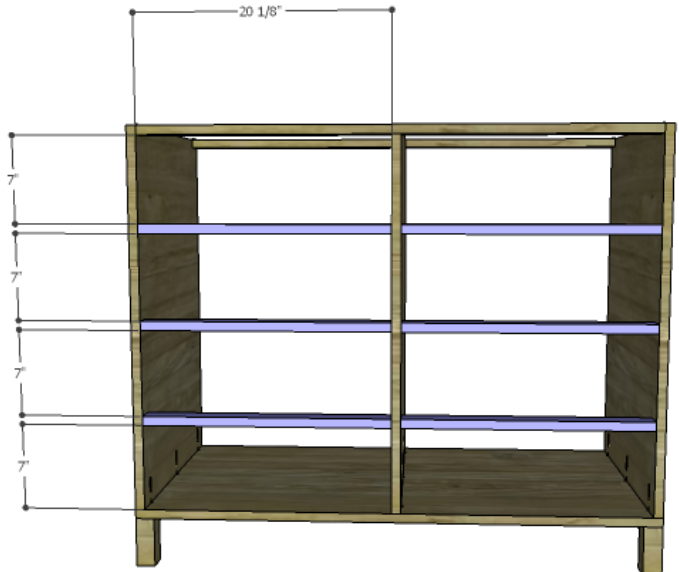

STEP 6

Cut the piece for the back. Secure the back to the sides, bottom, upper stretcher, and divider using glue and 1-1/4" brad nails.

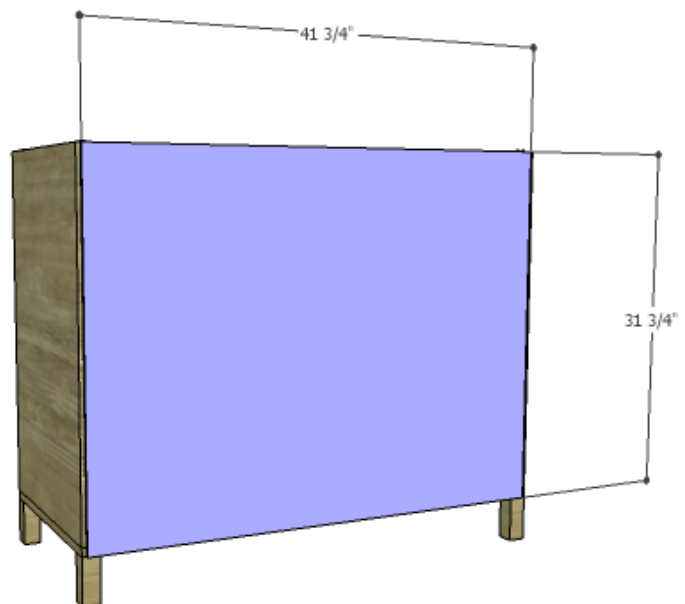

FEATURING
 **PureBond.**
FORMALDEHYDE-FREE TECHNOLOGY



Side By Side Dresser

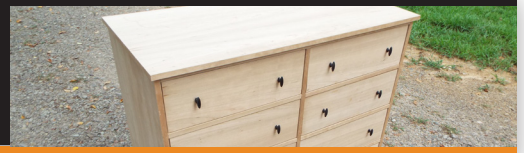

STEP 7

Cut the piece for the top. The top will be flush with the back and will overhang the sides and front by $\frac{1}{2}$ ". Secure the top using glue and 1-1/4" brad nails.

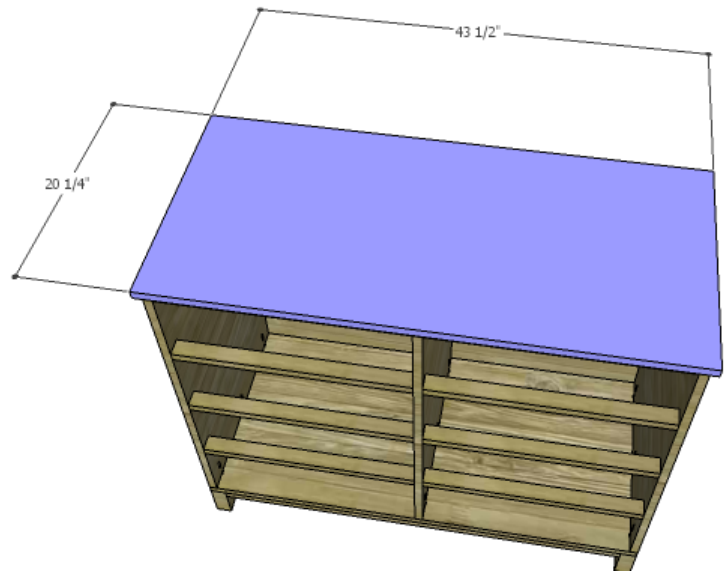

STEP 8

Cut the pieces for the drawer boxes. Drill pocket holes in all four edges of the bottom as well as each end of the sides. Assemble the drawer boxes as shown using glue and 1-1/4" pocket hole screws. Install the drawer slides according to the manufacturer's installation instructions, locating them $\frac{3}{4}$ " back from the front edge of the sides.

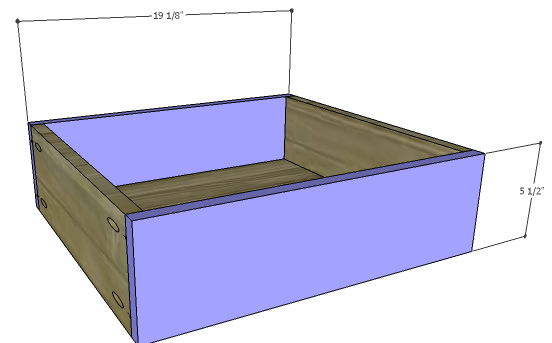
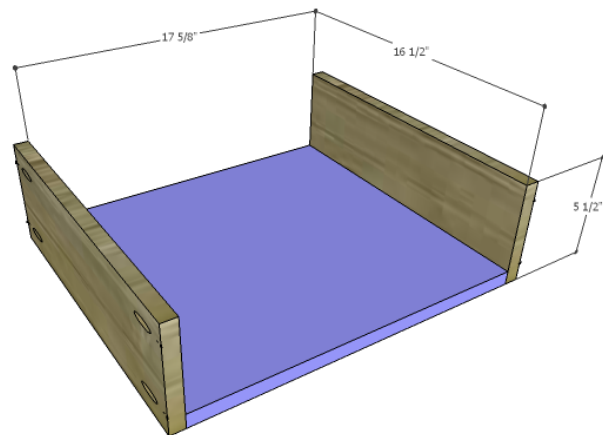

FEATURING
 **PureBond.**
FORMALDEHYDE-FREE TECHNOLOGY



Side By Side Dresser

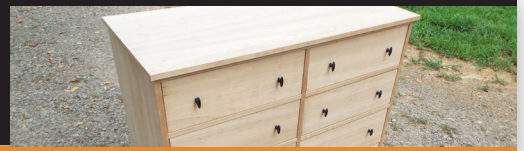

STEP 9

Cut the pieces for the drawer fronts. Mark the position for the drawer pulls and drill the holes. Shim the drawer front in the opening – there will be a 1/8" gap around all sides – then drive screws through the holes for the drawer pulls into the drawer box. Open the drawer and secure the drawer front using countersunk 1-1/4" screws from the inside. Remove the screws from the holes for the drawer pull then finish drilling the holes. Install the drawer pull.

Finish as desired.

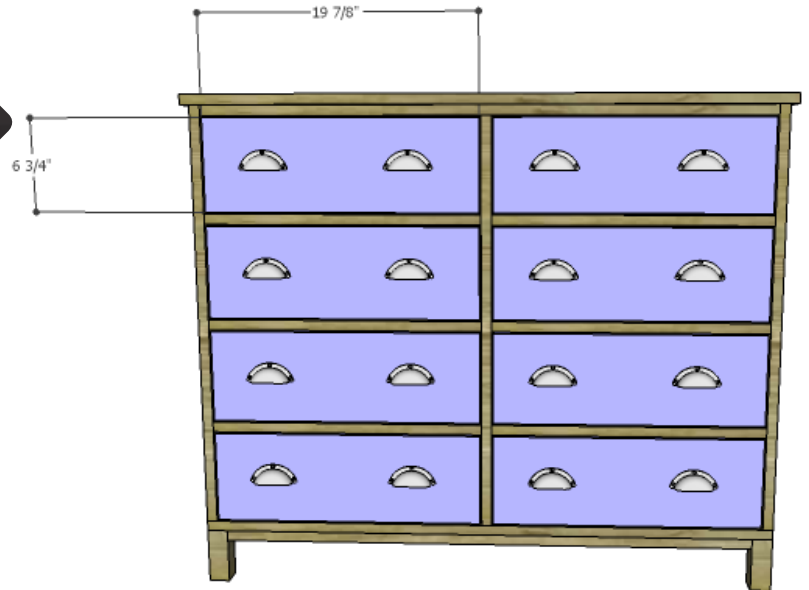

FEATURING
 **PureBond.**
FORMALDEHYDE-FREE TECHNOLOGY