

# Children's Locker

Free Plans to build a Children's Locker

**PureBond.**  
FORMALDEHYDE-FREE TECHNOLOGY

## Materials and Tools:

### MATERIALS:

- 1 - sheet 3/4" PureBond plywood (shown in oak)
- 4 - 4 feet long 1x3 boards in matching species
- 1 - half sheet 1/4" plywood in matching species
- 4 - caster wheels with plates
- 1 1/4" Pocket hole screws
- 1 1/4" finish nails
- Wood glue
- Edge Banding if staining

### Tools:

- Measuring Tape
- Square
- Pencil
- Safety Glasses
- Hearing Protection
- Kreg Jig™
- Drill
- Circular Saw
- Sander
- Countersink Drill Bit

### Cut List:

- 1 - 1x16 @ 48"
- 2 - 1x16 @ 14"
- 2 - 1x16 @ 10 3/4"
- 1 - 1x16 @ 46 1/2"
- 3 - 1x3 @ 46 1/2"
- 2 - 1x8 @ 36 1/4"
- 1 - 1x8 @ 46 1/2"
- 2 - 1x8 @ 33"
- 1 - 1/4" plywood 48" x 48"
- 3 - 1x8 @ 15"

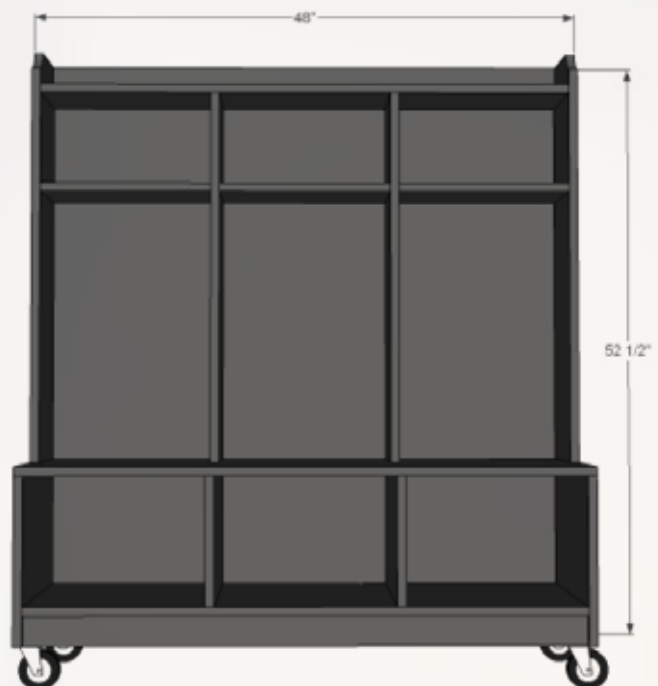

# Children's Locker

Free Plans to build a Children's Locker.

**PureBond**<sup>®</sup>  
FORMALDEHYDE-FREE TECHNOLOGY

## General Instructions:

Please read through the entire plan and all comments before beginning this project. It is also advisable to review the Getting Started Section. Take all necessary precautions to build safely and smartly. Work on a clean level surface, free of imperfections or debris. Always use straight boards. Check for square after each step. Always predrill holes before attaching with screws. Use glue with finish nails for a stronger hold. Wipe excess glue off bare wood for stained projects, as dried glue will not take stain. Be safe, have fun, and ask for help if you need it. Good luck!

## Step #1

The first step is to cut your PureBond Plywood into more manageable strips. I suggest first ripping two strips from the full sheet into 15 3/4" wide strips, 8 feet long. Then cut your big pieces from these. Take all the scraps and rip into 7 3/4" wide strips.

You'll want to also drill all of your pocket holes at this stage. Go through the plan and mark each board where you will need a PH and drill. You will need to use 3/4" PHs and 1 1/4" PH screws.

## Step #2

Start by assembling the base storage compartments as shown in the diagram. Measure and mark out the joint locations with a square and attach with 1 1/4" PH screws.

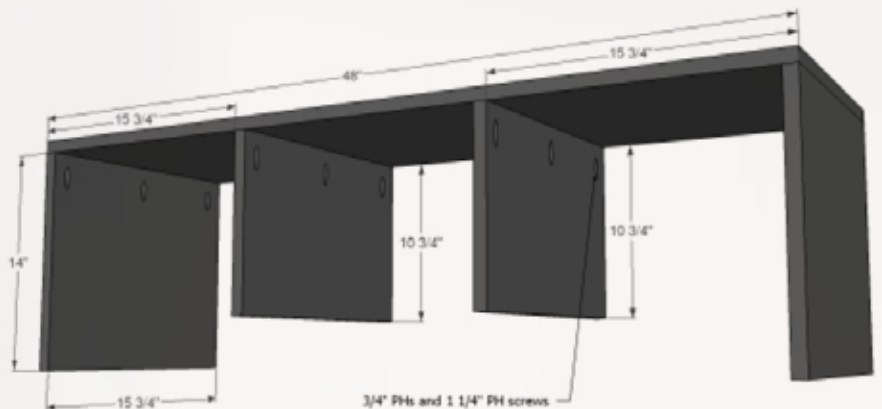
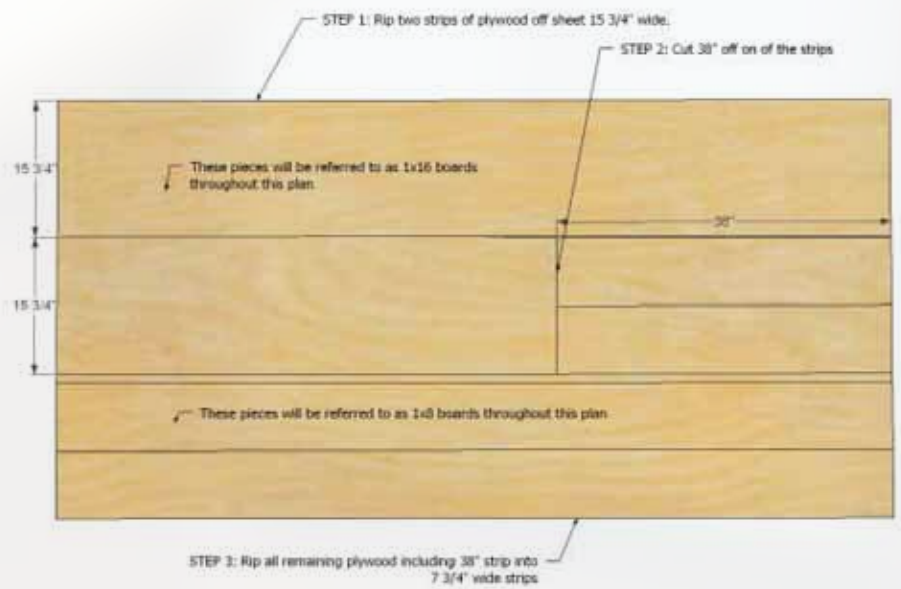

# Children's Locker

Free Plans to build a Children's Locker.

**PureBond.**  
FORMALDEHYDE-FREE TECHNOLOGY

## Step #3

Mark out the cubby divider locations with a square, and then attach this time with countersunk screws.

## Step #4

Drill pocket holes along top edge and ends of the footers. Attach inset slightly to the base. I actually nailed and glued for the session - which works just fine.

## Step #5

Now we get to start building that hutch! Start by attaching the sides to the base.

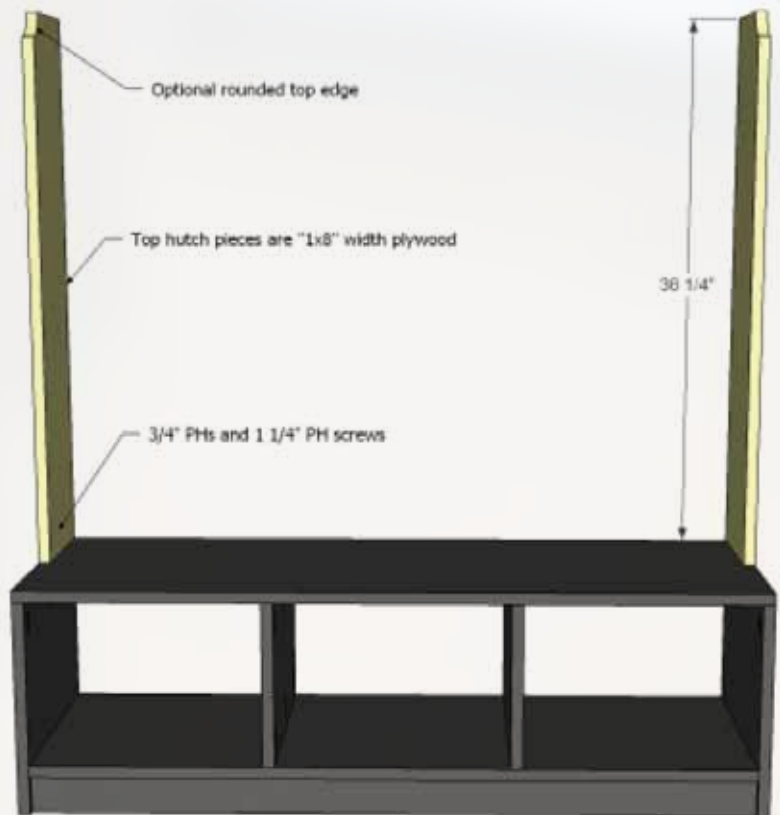
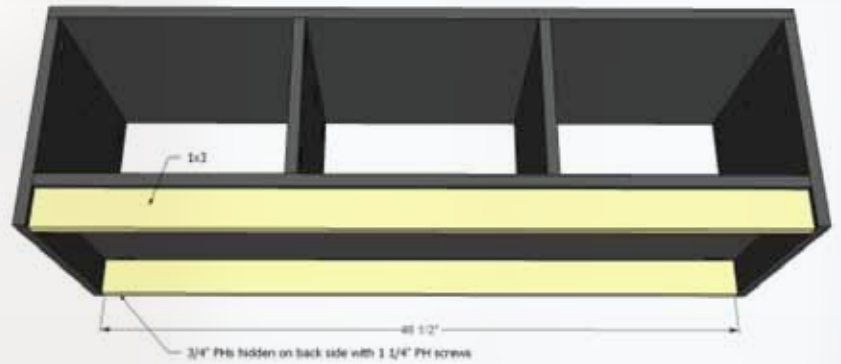
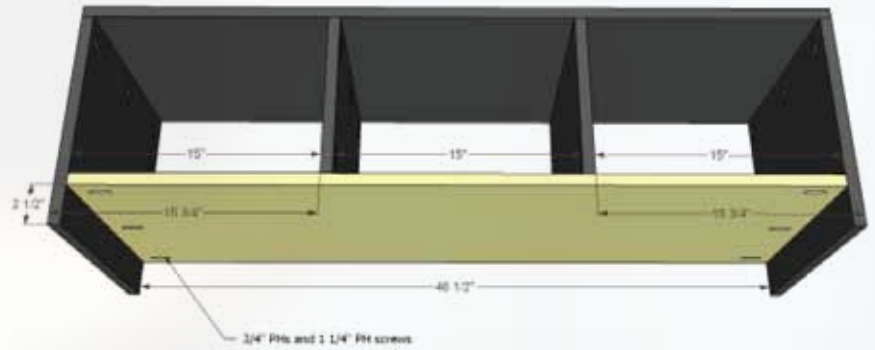



# Children's Locker

Free Plans to build a Children's Locker.

**PureBond.**  
FORMALDEHYDE-FREE TECHNOLOGY

## Step #6



Now the top shelf. Measure and mark out the location.

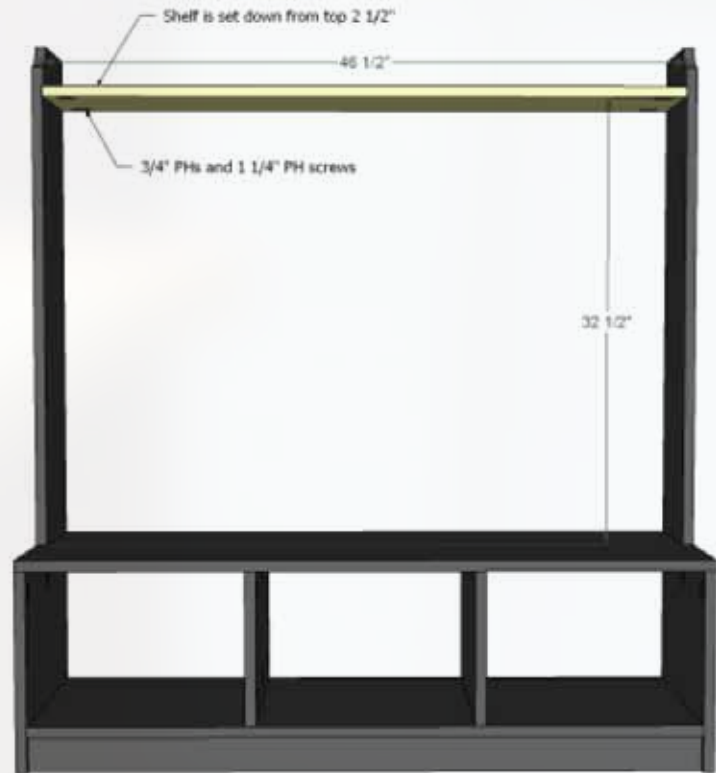

## Step #7



And then attach the dividers.  
NOTE: These should actually be 33" long.

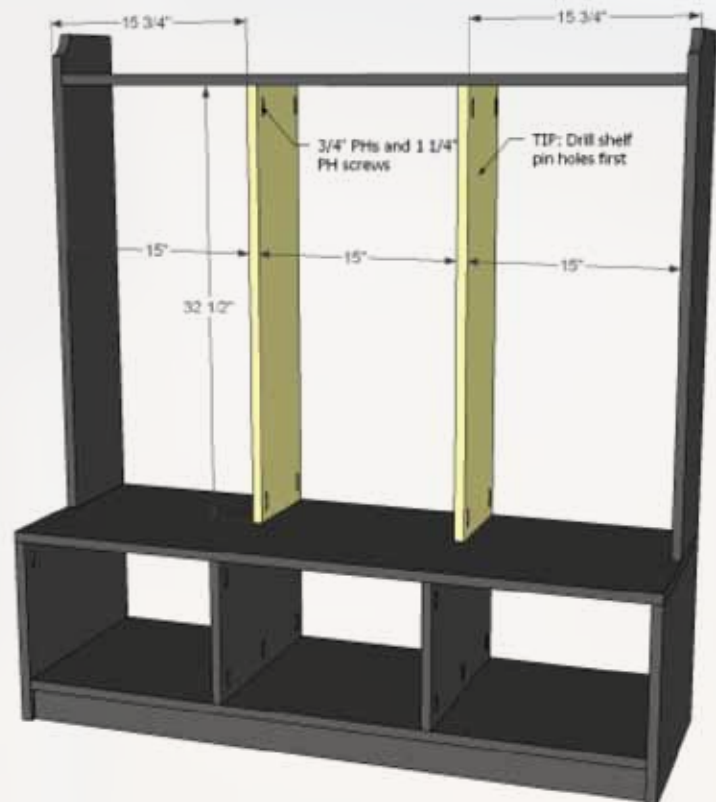

# Children's Locker

Free Plans to build a Children's Locker.

**PureBond.**  
FORMALDEHYDE-FREE TECHNOLOGY



## Step #8



Followed by the back header - do the same, drill PHs along ends and bottom edge and attach as you did the footers.



## Step #9



Finally, attach back with glue and nails.

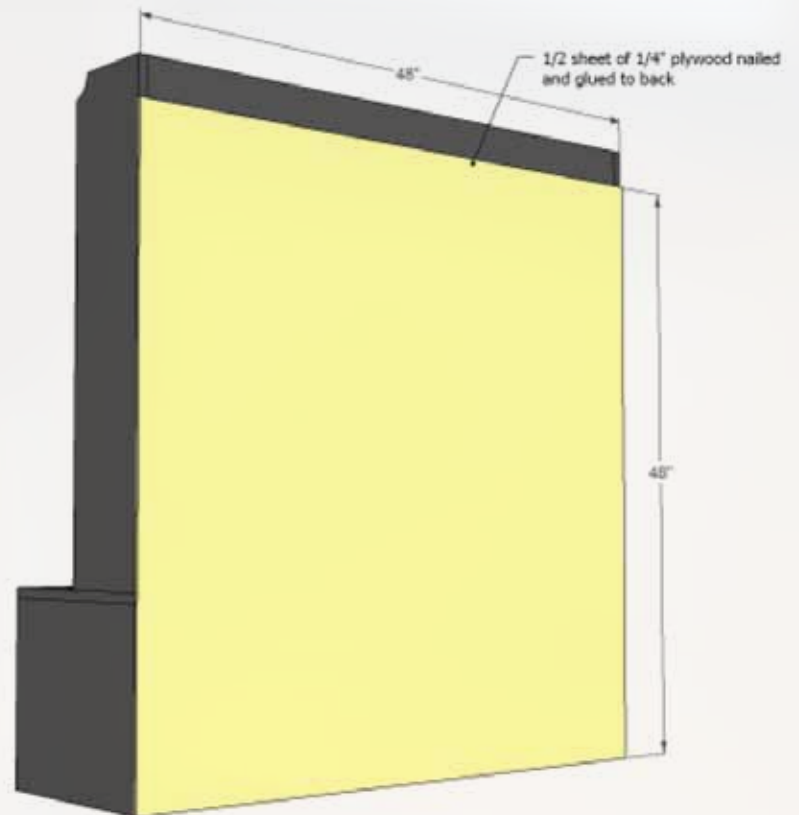

# Children's Locker

Free Plans to build a Children's Locker.

**PureBond.**  
FORMALDEHYDE-FREE TECHNOLOGY

## Step #10



NOTE: For the shelves, I used shelf pins and recommend attaching a 1x3 to back underside of the shelf to attach hooks to. Then when you move your shelf down or up, the hook goes too.

### Preparation Instructions:

Fill all holes with wood filler and let dry. Apply additional coats of wood filler as needed. When wood filler is completely dry, sand the project in the direction of the wood grain with 120 grit sandpaper. Vacuum sanded project to remove sanding residue. Remove all sanding residue on work surfaces as well. Wipe project clean with damp cloth. It is always recommended to apply a test coat on a hidden area or scrap piece to ensure color evenness and adhesion. Use primer or wood conditioner as needed.

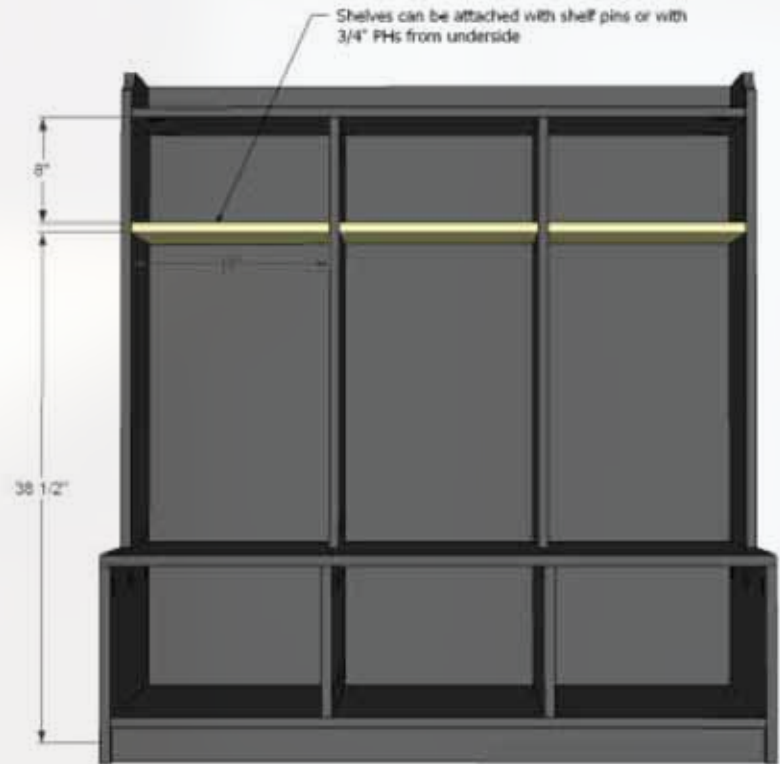

FEATURING

**PureBond.**

FORMALDEHYDE-FREE TECHNOLOGY

[www.purebondplywood.com](http://www.purebondplywood.com)