



Wall Shelf

Free Plans to build a Wall Shelf.



Materials and Tools

MATERIALS:

- 1" brad nails
- 1-1/4" brad nails
- Edge banding, optional
- Wood glue
- Sandpaper (100, 150, 220 grits)
- Finishing supplies (primer & paint, or stain, sealer)

Lumber:

- 1 - 2' x 4' x 1/2" PureBond plywood project panel
- 1 - 2' x 4" x 1/4" PureBond plywood project panel (Walnut was used for the example)

Tools:

- Jigsaw, table saw, miter saw, or hand saw
- Pocket hole jig
- Brad nailer
- Drill
- Pencil, ruler, square
- Tape measure
- Sander
- Iron for edge banding
- Edge banding trimmer or craft knife

Cut List:

- 4 - 1/2" PureBond Plywood project panel at 3" x 17" - Shelves
- 1 - 1/2" PureBond Plywood project panel at 3" x 11" - Upper Divider
- 3 - 1/2" PureBond Plywood project panel at 3" x 9" - Middle & Lower Divider
- 2 - 1/2" PureBond Plywood project panel at 3" x 5" - Middle Shelves
- 1 - 1/2" PureBond Plywood project panel at 3" x 7-1/2" - Lower Shelf

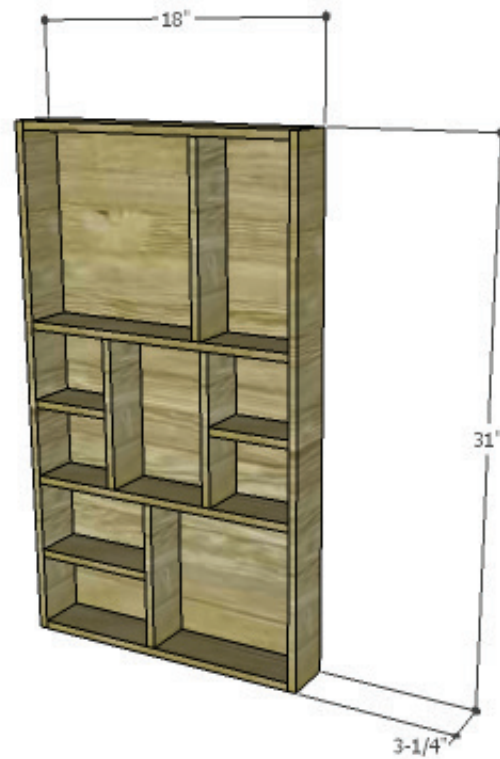

FEATURING
 PureBond.[®]
FORMALDEHYDE-FREE TECHNOLOGY



Wall Shelf



STEP 3

Cut the piece for the back. Secure to the back of the wall shelf using glue and 1" brad nails.

Finish as desired.

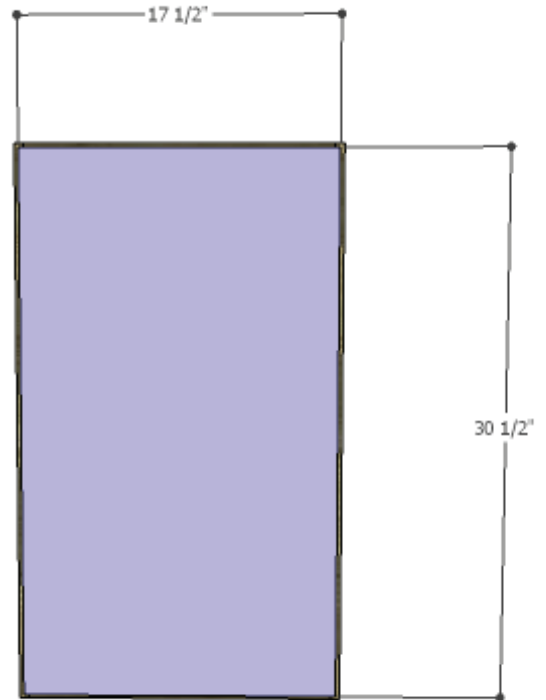

FEATURING
 PureBond.[®]
FORMALDEHYDE-FREE TECHNOLOGY